

# JCISD Oak Grove Protection Plan

## 1226 S Wisner St Jackson,MI 49203

Inventoried all trees in the grove between Cascades Elementary and the new JCISD building. Tree size, species, and a map will be listed below along with recommendations for each. I am available for a site visit for any concerns that are listed below, you will see below the abbreviation DBH which is (Diameter at Breast Height). Tree#1 *Swamp White Oak (Quercus Bicolor)* 59.5" DBH is in the path of the new proposed roadway and needs to be removed. Tree#2 (*Aesculus Hippocastanum*) or *Horse Chestnut* 21.5" DBH is in the path of the new proposed road and needs to be removed. We did look at transplanting this tree to another location on the property but after the evaluation of the tree there is some decay on the backside of the tree that would not make it a good candidate for a successful transplant. Tree#3 *Swamp White Oak (Quercus Bicolor)* 42.5" DBH is in the path of the new proposed road and needs to be removed. Tree#4 *Swamp White Oak (Quercus Bicolor)* 52.5" DBH does have some included bark but appears to be healthy, recommending to dead wood the canopy and some light elevation work. Tree#5 *Swamp White Oak (Quercus Bicolor)* 28.5" DBH will need to be trimmed back from the new proposed road for clearance of the buses This tree has a lot of deadwood in the crown that needs to be removed. It will be important for me to work with the civil engineer to make sure soil compaction near the tree is mitigated and proper curbing is used to move road salt runoff away from the tree. Doing this will provide the best protection for the tree moving forward. Tree#6 *Swamp White Oak (Quercus Bicolor)* 46" DBH does have some included bark and decay in the canopy recommending to dead wood the canopy and light elevation work. Tree#7 *Swamp White Oak (Quercus Bicolor)* 43" DBH does have some included bark and deadwood in the canopy recommending to dead wood the canopy and light elevation work. Tree#8 *Swamp White Oak (Quercus Bicolor)* 37.5" DBH does have included bark and deadwood in the canopy recommending to deadwood the canopy and light elevation work. Tree#9 *Swamp White Oak (Quercus Bicolor)* 33.5" DBH does have some included bark and deadwood in the canopy recommending to deadwood the canopy and light elevation work. Tree#10 *Swamp White Oak (Quercus Bicolor)* 54" DBH is a co-dominant tree with a good portion leaning towards Cascades Elementary recommending to cable the tree in the future to ensure the two stems stay intact, also recommend to deadwood the canopy and light elevation. Tree#11 *Swamp White Oak (Quercus Bicolor)* 37.5" DBH tree does have deadwood in the canopy recommending to deadwood the canopy and light elevation work. Tree#12 *Swamp White Oak (Quercus Bicolor)* 47" DBH does have some included bark and some deadwood in the canopy recommending to dead wood the canopy and light elevation work. Tree#13 *Swamp White Oak (Quercus Bicolor)* 34" DBH tree appears to have some internal decay that has healed over doesn't seem to be an issue at this point, tree also has some included bark and deadwood in the canopy. Recommending to deadwood the canopy and light elevation I would put this tree on the "watch list." Tree#14 *Swamp White Oak (Quercus Bicolor)* 43.5" DBH has some included bark and deadwood in the canopy recommending to deadwood the canopy and some light elevation work. Tree#15 *Swamp White Oak (Quercus Bicolor)* 33.5" DBH has some included bark and deadwood in the canopy recommending to deadwood the canopy and light elevation work.

In all, the grove of trees appears to be healthy and nothing jumps out at me as a hazard that should be addressed at this time, I would like to get some soil samples sent off to the lab and get a plan for a broadcasted fertilizer to help the trees thrive once the roadway is underway. I would also recommend

that we grind as much of the stumps out as possible before excavation takes place to ensure we don't disrupt the other trees roots, we typically can get most of the stump down to 18" below grade at that point there will be no risk of disrupting the other tree roots.

Respectfully Submitted

Chad Fox ISA Certified Arborist MI-4168AU

Chad Fox 3/21/22

S. Durand St.

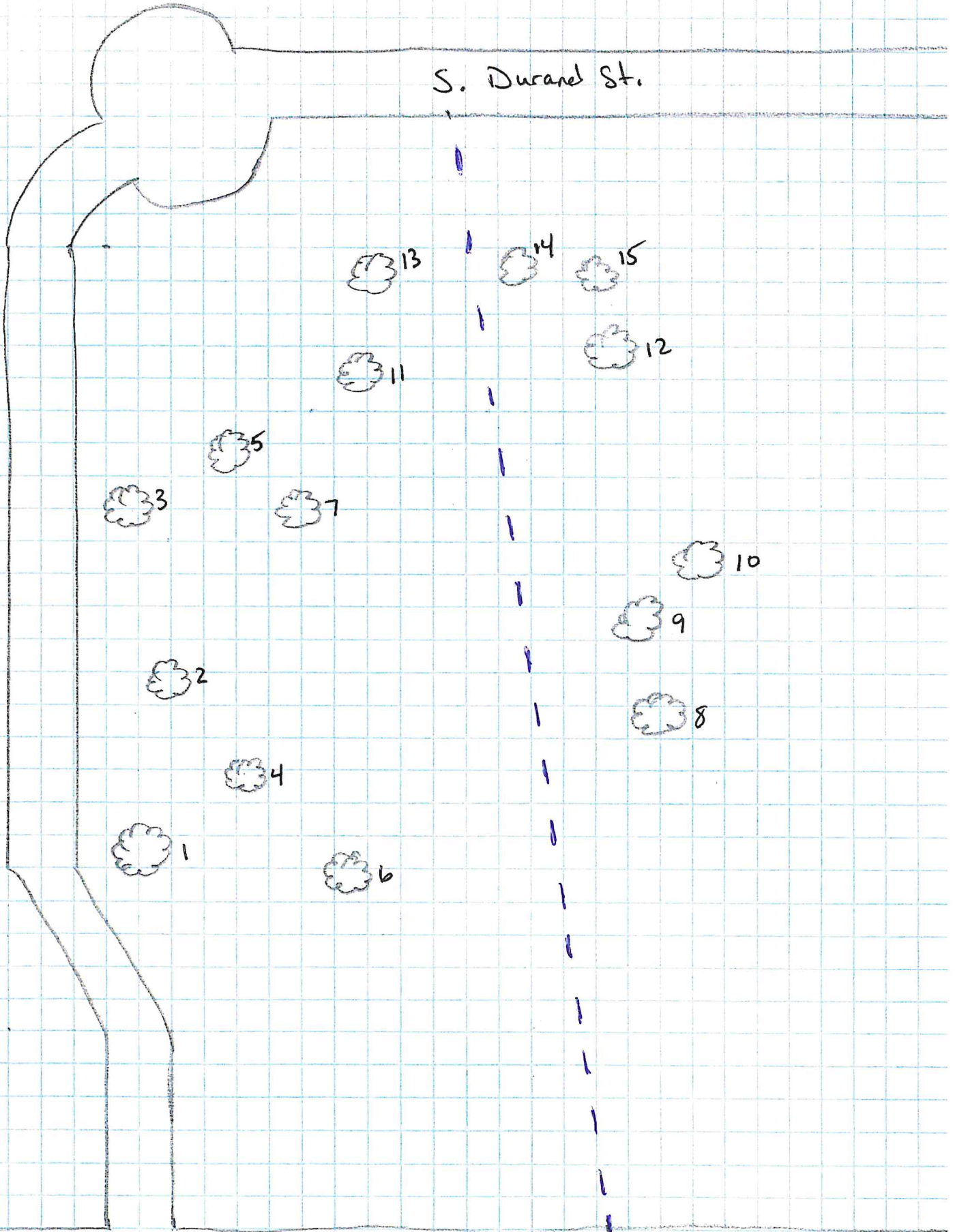

S. WISNER ST